

TRIMLESS KIT

INSTALLATION INSTRUCTION

1. ceiling
2. support structure
3. plaster finish
4. trim kit
5. luminaire
6. diffuser
7. fixing screws (not included)

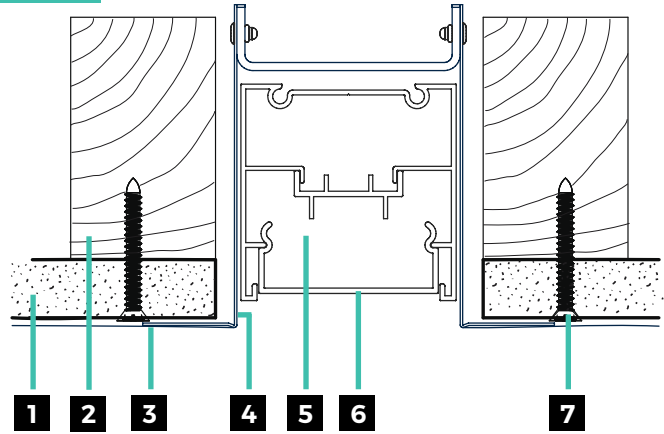

1 Identify contents

- 3 x reveal angles
- 16 x tek screws
- 4 x trim kit brackets
- 1 x Spacer
- 1 x Luminaire
- 1 x Instruction Sheet

2 Assemble the kit

Ensure the trim kit bracket is 100mm from each end
Allow power entry flex space to exit the fitting

3 Prepare opening

use spacer provided to check gap

4 Fix trim to ceiling with fasteners

maintain gap with spacer

5 Prepare ends with cut sides

Please ensure you allow a 1.5mm space for clearance

6 Test fit luminaire

Make sure the opening fits into the hole before plastering

7 Plaster over trim

8 Remove diffuser & geartray

geartray

diffuser

9 Drill fixing holes

Drill fixing holes in back of luminaire that align with the spreaders of mounting luminaire

10 Connect power

11 Attach luminaire

Attach luminaire body into trimless channel (fasteners not supplied)

12 reassemble geartray & diffuser

If more information is required please contact your local representative by going to xerolighting.com/contacts or email us at headoffice@xerolighting.com