

INSTALLATION INSTRUCTION

- 1 Beam or support
- 2 Fastener
- 3 Ceiling
- 4 Rollerball barrel
- 5 Suspension Wire
- 6 Clutch
- 7 Curved Endplate
- 8 Diffuser

Installer must ensure that the slot orientation in ceiling barrel allows suspension wire to remain perpendicular at all times in all orientations

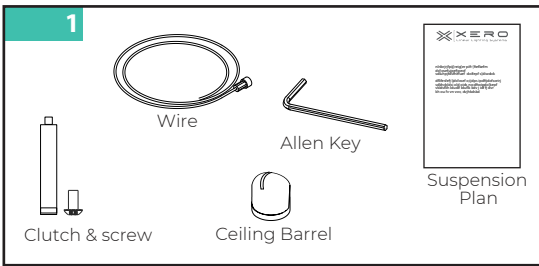
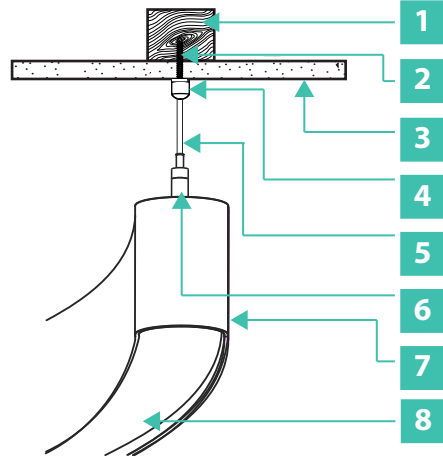

Determine mounting location

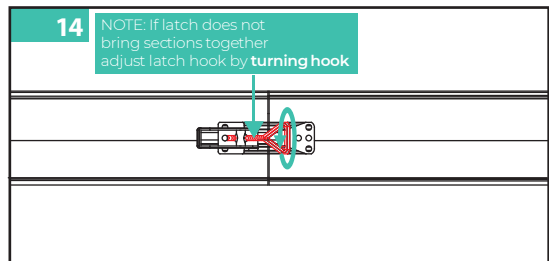
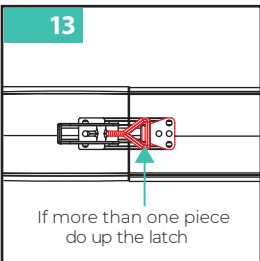
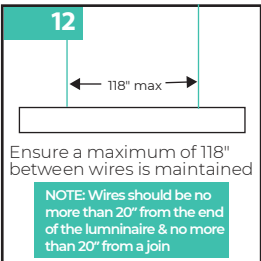
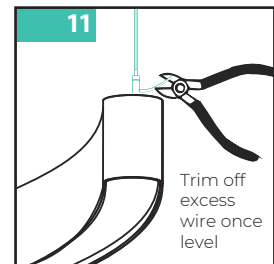
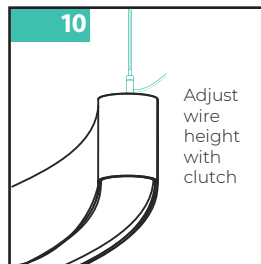
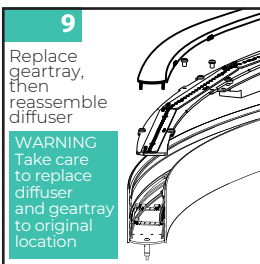
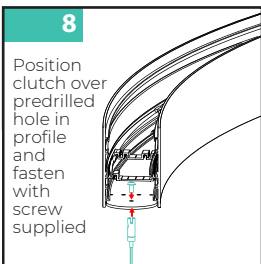
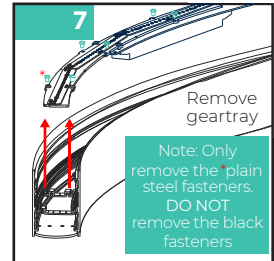
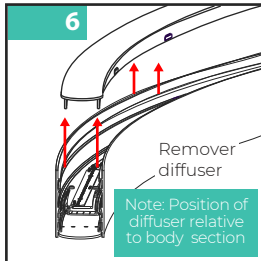
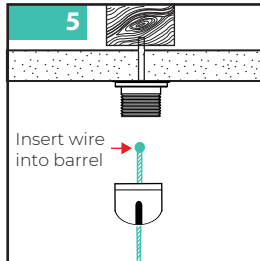
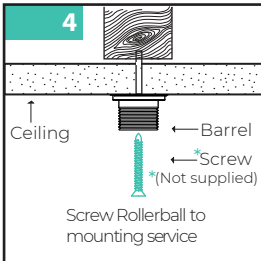
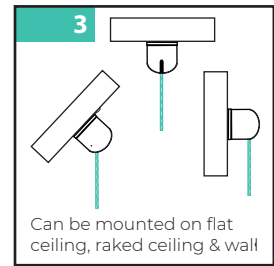

NOTE: Wires should be no